

## Top cabinet, the crown on your PAX wardrobe

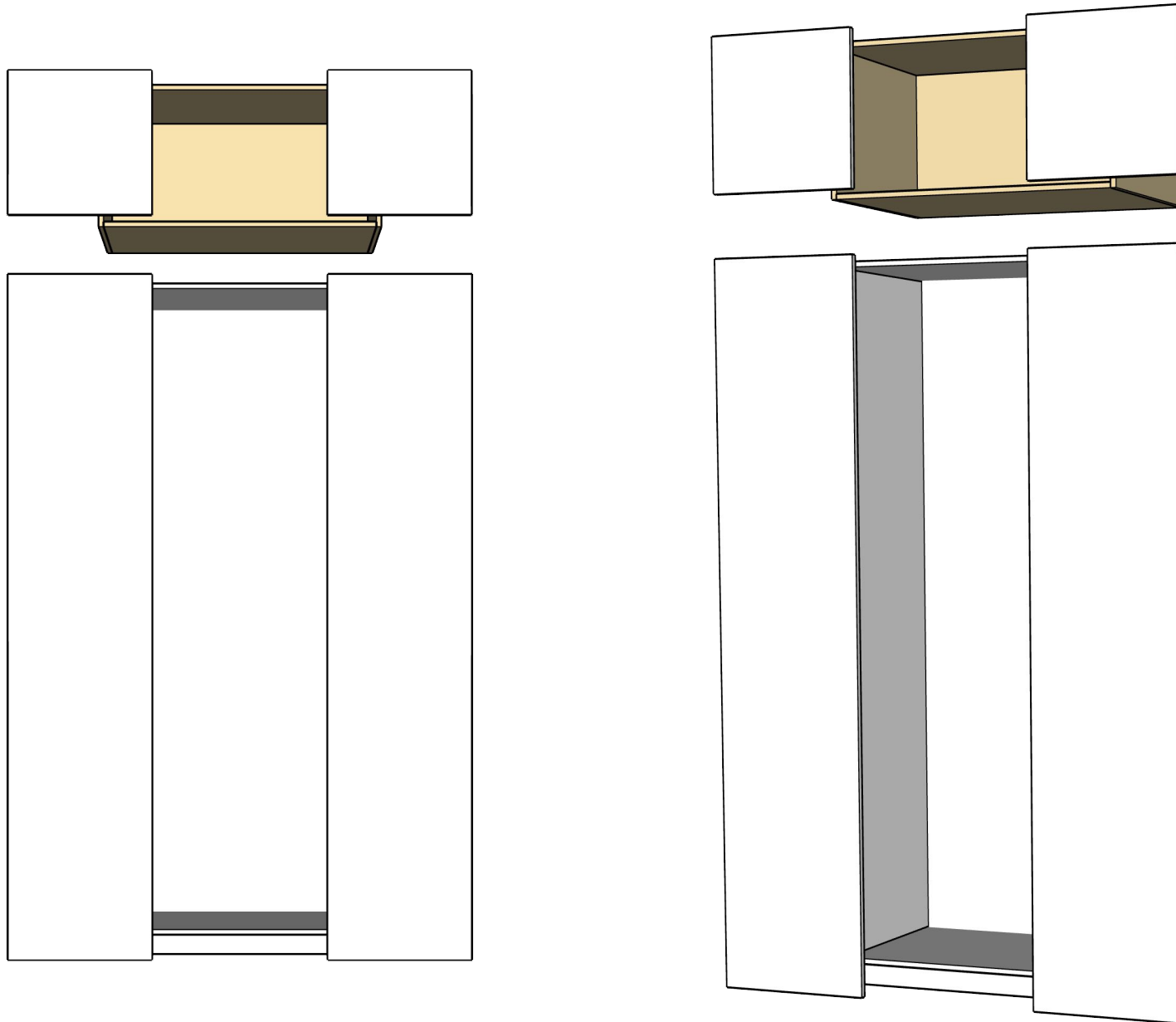

## Panels

2x **Side**

2x **Top/Bottom**

1x **Back**

Xx **Shelve** [depending on the height of the top cabinet]

## Assembly parts

Cabinet 580 mm deep = 12 Cabineo connectors + cover caps

Cabinet 355 mm deep = 8 Cabineo connectors

1x Allen key [1/4", rounded head]

4x Shelf supports per shelf

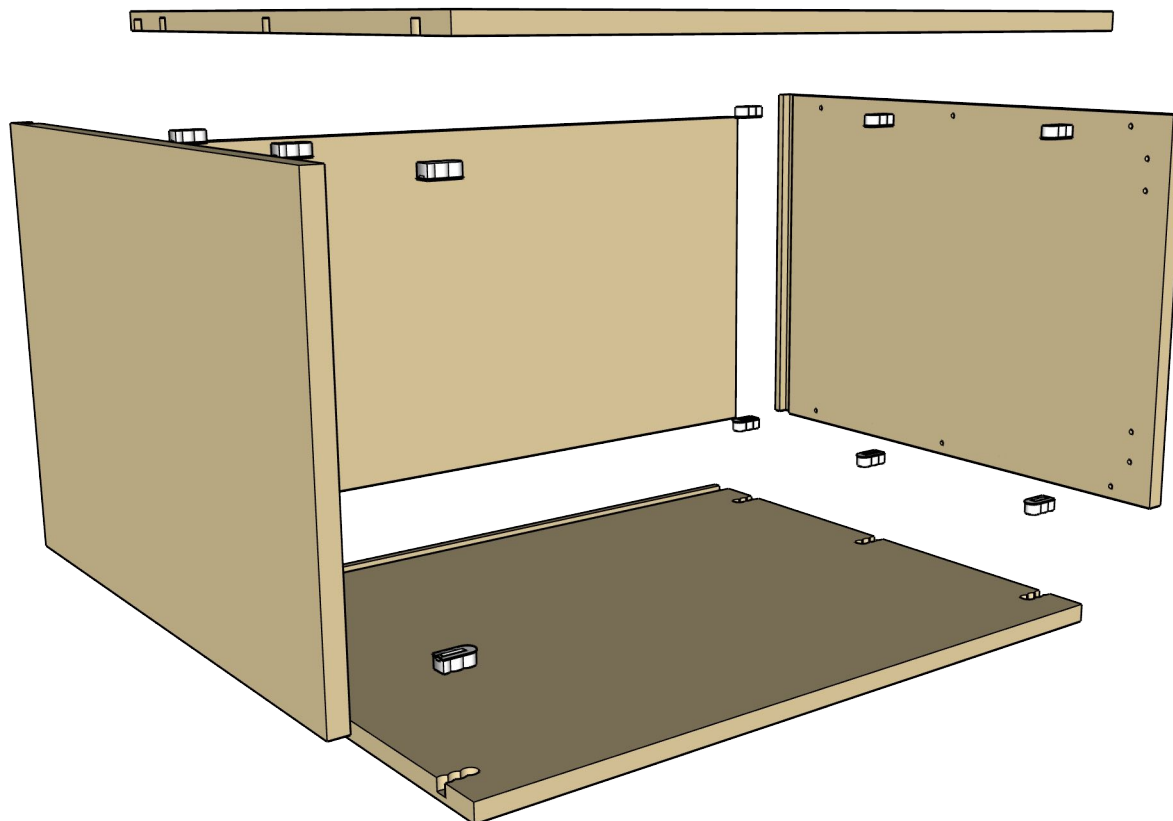

## Step-by-step instructions

1. Insert the Cabineo connectors into the top and bottom panels and gently tap them into the pre-drilled holes using a hammer.

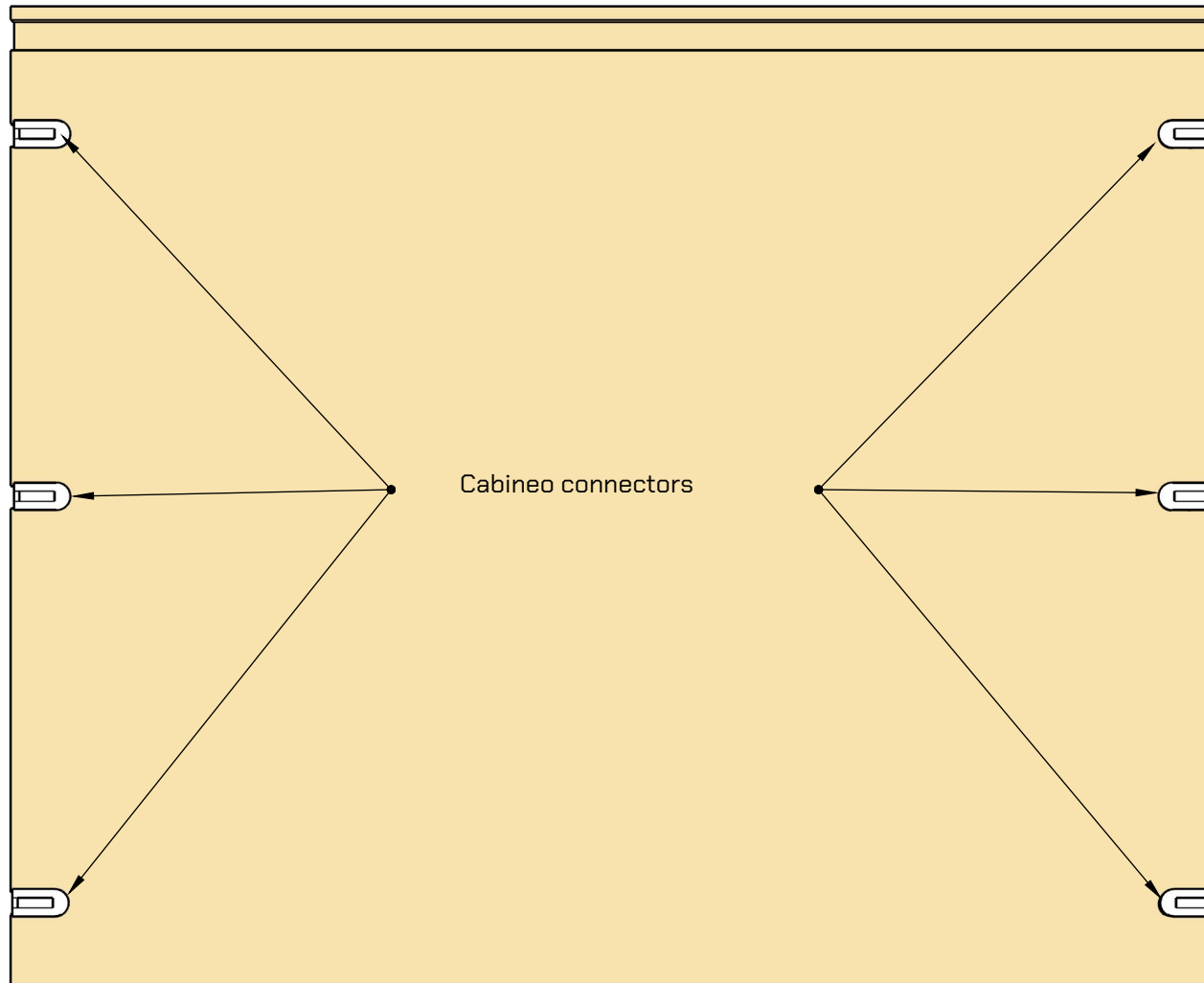

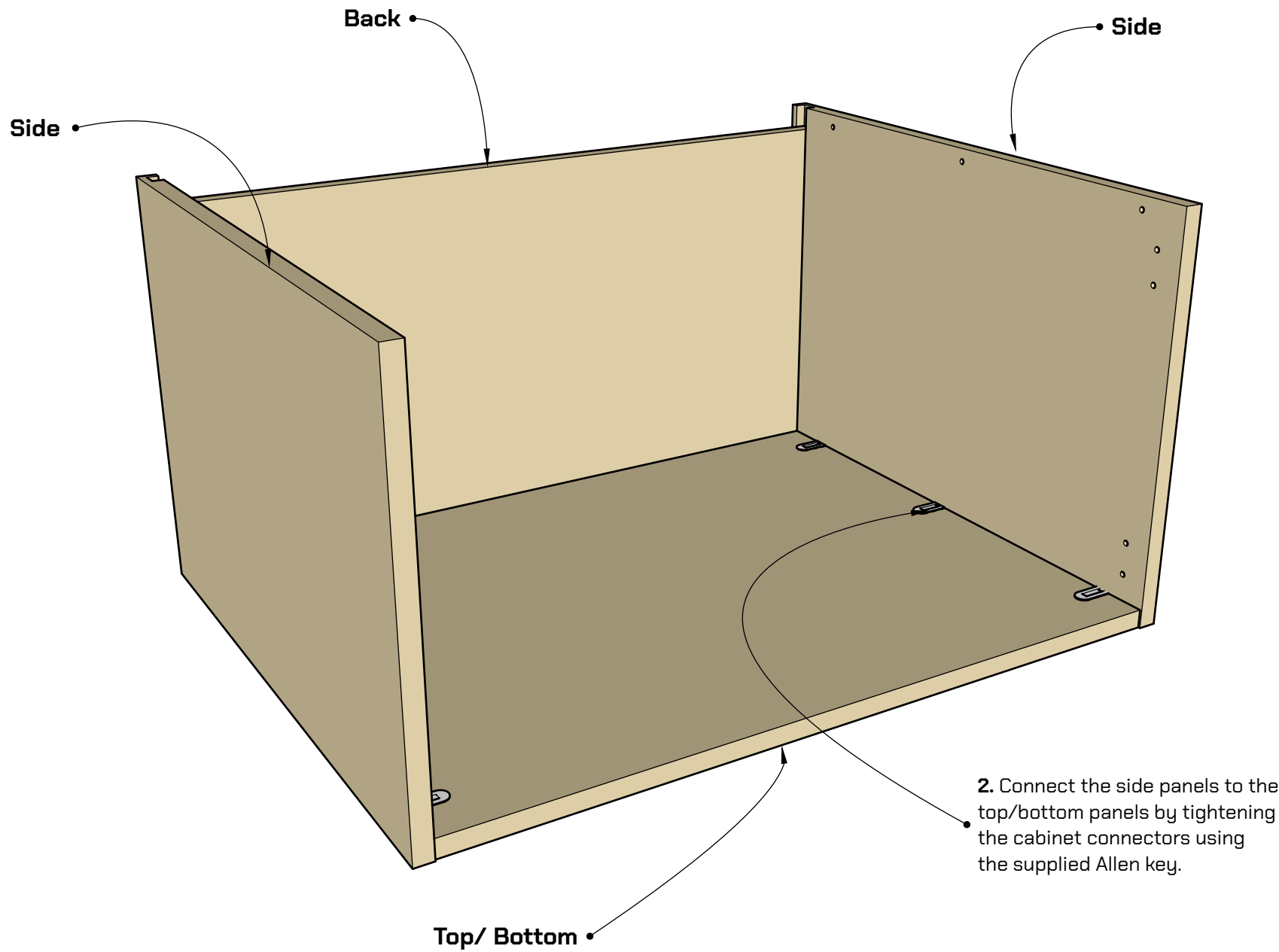

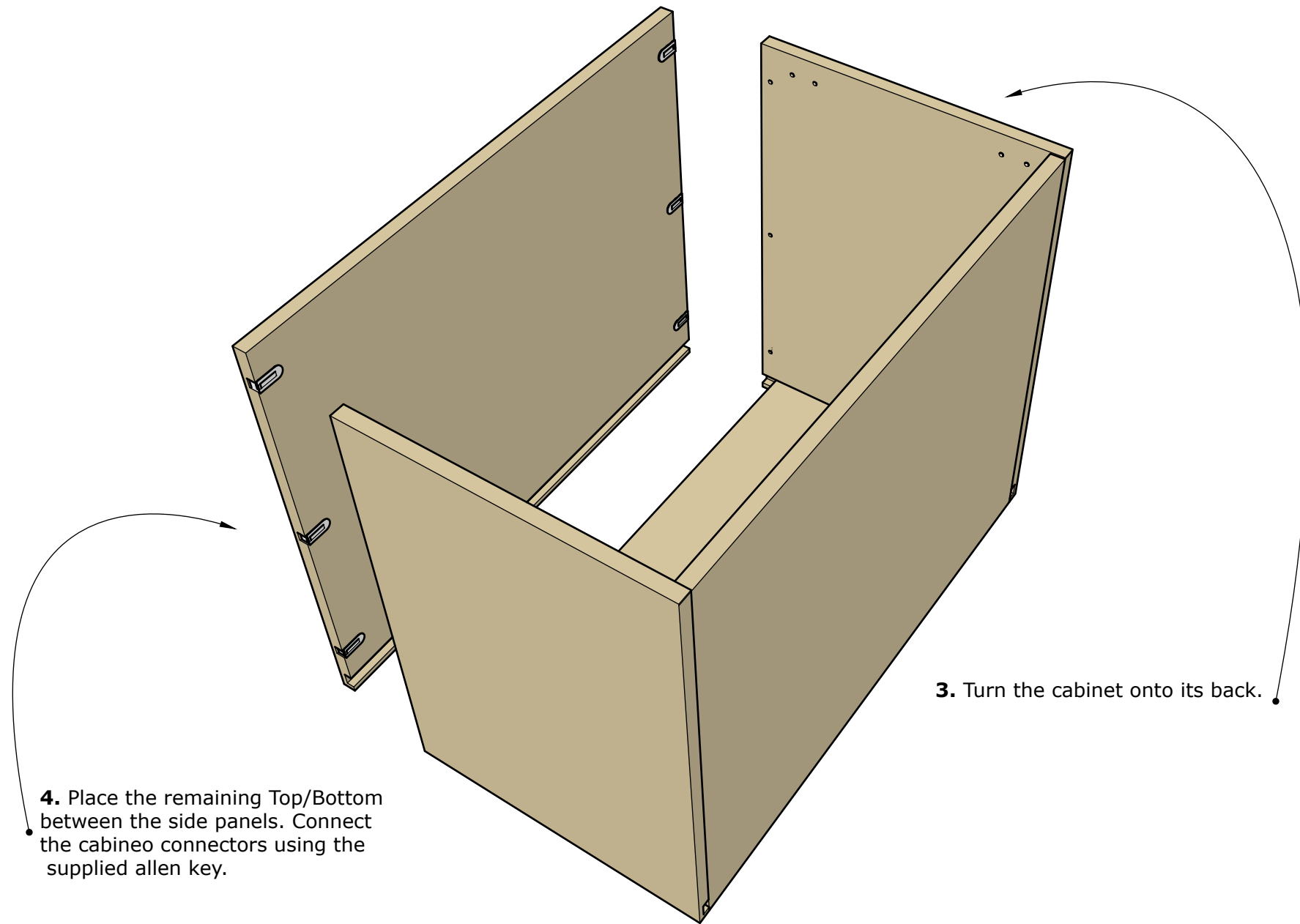

**4.** Place the remaining Top/Bottom between the side panels. Connect the cabineo connectors using the supplied allen key.

**3.** Turn the cabinet onto its back.